

# M5 Junction 10 Improvements Scheme

## Streets, Rights of Way and Access Plans – Part 2 TR010063 – APP 2.5

Regulation 5 (2) (k)

Planning Act 2008

Infrastructure Planning (Applications: Prescribed Forms and Procedure) Regulations 2009

Volume 2

November 2024

THIS PAGE IS LEFT INTENTIONALLY BLANK

## Infrastructure Planning Planning Act 2008

### The Infrastructure Planning (Applications: Prescribed Forms and Procedure) Regulations 2009

#### M5 Junction 10 Improvements Scheme Development Consent Order 202[X]

---

#### Streets, Rights of Way and Access Plans – Part 2

---

<b>Regulation Number:</b>	Regulation 5 (2) (k)
<b>Planning Inspectorate Scheme Reference</b>	TR010063
<b>Application Document Reference</b>	TR010063 – APP 2.5
<b>Author:</b>	M5 Junction 10 Improvements Scheme Project Team

<b>Version</b>	<b>Date</b>	<b>Status of Version</b>
Rev 0	December 2023	DCO Application
Rev 1	September 2024	Deadline 4
Rev 2	November 2024	Deadline 10

# 1. Schedule of Plans included in the application

## 1.1. List of drawings in Part 1

Document title	Document number	Version
Streets, Rights of Way and Access Plans Regulation 5(2)(k) Key Plan	TR010063 – APP 2.5	<del>C02</del> <del>C04</del>
Streets, Rights of Way and Access Plans Regulation 5(2)(o) Sheet 1 of 16	TR010063 – APP 2.5	C01
Streets, Rights of Way and Access Plans Regulation 5(2)(o) Sheet 2 of 16	TR010063 – APP 2.5	C01
Streets, Rights of Way and Access Plans Regulation 5(2)(o) Sheet 3 of 16	TR010063 – APP 2.5	C01
Streets, Rights of Way and Access Plans Regulation 5(2)(o) Sheet 4 of 16	TR010063 – APP 2.5	<del>C02</del> <del>C04</del>
Streets, Rights of Way and Access Plans Regulation 5(2)(o) Sheet 5 of 16	TR010063 – APP 2.5	<del>C03</del> <del>C02</del>
Streets, Rights of Way and Access Plans Regulation 5(2)(o) Sheet 6 of 16	TR010063 – APP 2.5	<del>C02</del> <del>C04</del>
Streets, Rights of Way and Access Plans Regulation 5(2)(o) Sheet 7 of 16	TR010063 – APP 2.5	C01
Streets, Rights of Way and Access Plans Regulation 5(2)(o) Sheet 8 of 16	TR010063 – APP 2.5	C01
Streets, Rights of Way and Access Plans Regulation 5(2)(o) Sheet 9 of 16	TR010063 – APP 2.5	C01
Streets, Rights of Way and Access Plans Regulation 5(2)(o) Sheet 10 of 16	TR010063 – APP 2.5	C01



## 1.2. List of drawings in Part 2

Document title	Document number	Version
Streets, Rights of Way and Access Plans Regulation 5(2)(o) Sheet 11 of 16	TR010063 – APP 2.5	C01
Streets, Rights of Way and Access Plans Regulation 5(2)(o) Sheet 12 of 16	TR010063 – APP 2.5	<del>C02</del> <del>C04</del>
Streets, Rights of Way and Access Plans Regulation 5(2)(o) Sheet 13 of 16	TR010063 – APP 2.5	C01
Streets, Rights of Way and Access Plans Regulation 5(2)(o) Sheet 14 of 16	TR010063 – APP 2.5	C01
Streets, Rights of Way and Access Plans Regulation 5(2)(o) Sheet 15 of 16	TR010063 – APP 2.5	<del>C03</del> <del>C02</del>
Streets, Rights of Way and Access Plans Regulation 5(2)(o) Sheet 16 of 16	TR010063 – APP 2.5	<del>C02</del> <del>C04</del>

















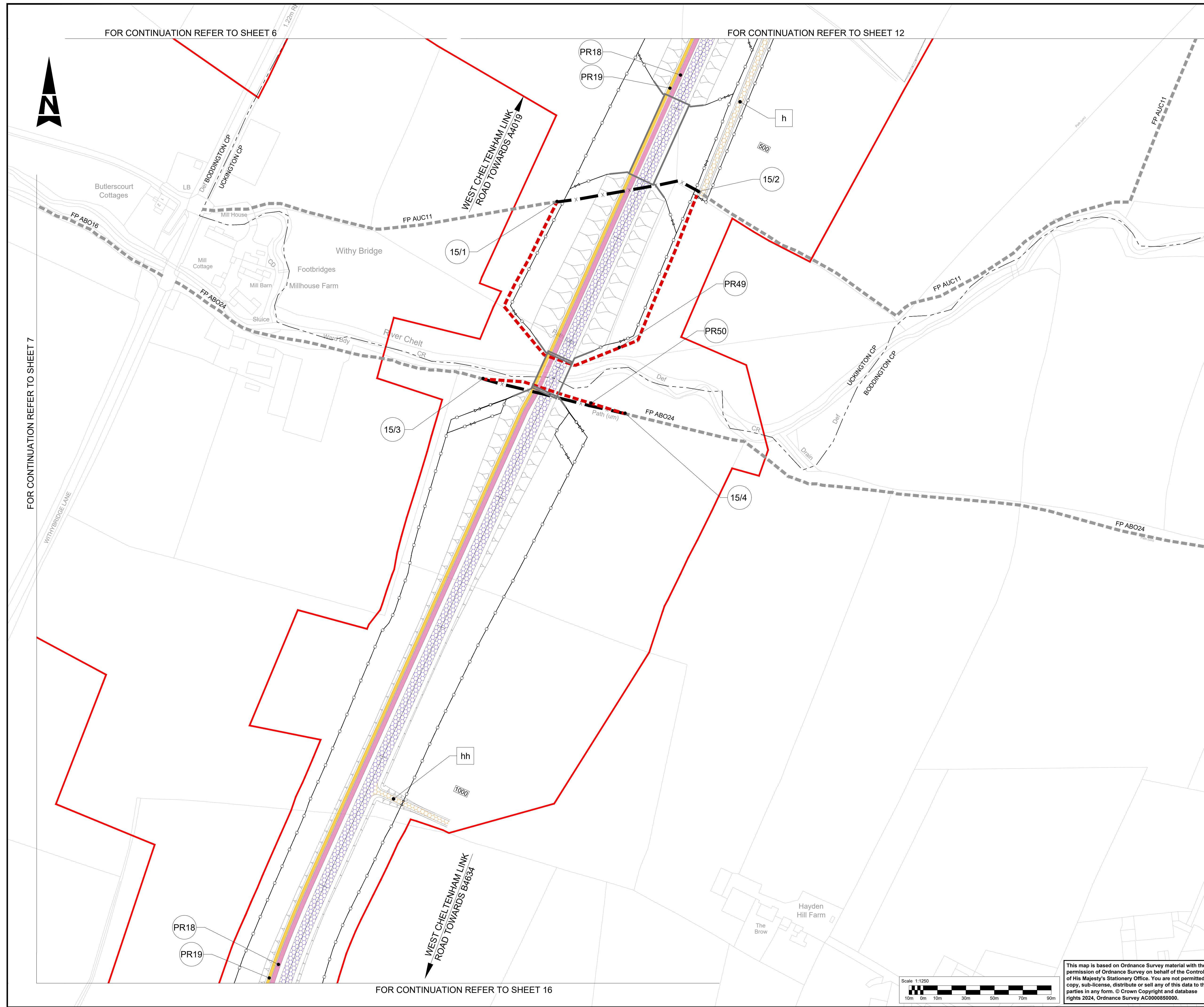

- NOTES:**
- THE STREETS, RIGHTS OF WAY AND ACCESS PLANS SHOULD BE READ IN CONJUNCTION WITH THE DEVELOPMENT CONSENT ORDER AND OTHER APPLICATION PLANS.
- KEY:**
- DEVELOPMENT CONSENT ORDER (DCO) LIMITS
  - THE SCHEME (SHOWN FOR ILLUSTRATIVE PURPOSES ONLY)
  - EXISTING ORDNANCE SURVEY DATA
  - NEW, ALTERED OR IMPROVED HIGHWAY - MOTORWAY
  - NEW, ALTERED OR IMPROVED HIGHWAY - SIDE ROADS
  - NEW / ALTERED PRIVATE MEANS OF ACCESS
  - NEW OR ALTERED FOOTWAY
  - NEW CYCLE TRACK
  - NEW NON SEGREGATED FOOTWAY / CYCLE TRACK
  - EXISTING HIGHWAYS TO BE STOPPED UP
  - PRIVATE MEANS OF ACCESS TO BE STOPPED UP
  - FP XXX - EXISTING PUBLIC RIGHT OF WAY (PROW)
  - X - EXISTING PUBLIC RIGHT OF WAY TO BE STOPPED UP
  - NEW / SUBSTITUTED FOOTPATH
  - NEW / SUBSTITUTED BRIDLEWAY
  - PROPOSED FENCE LINE
  - PR - REFERENCE LABEL FOR NEW PUBLIC RIGHT OF WAY, FOOTWAY, CYCLE TRACK, OR COMBINED FOOTWAY AND CYCLE TRACK
  - A - REFERENCE LABEL FOR EXISTING PRIVATE MEANS OF ACCESS TO BE STOPPED UP
  - a - REFERENCE LABEL FOR NEW/SUBSTITUTED PRIVATE MEANS OF ACCESS
  - h - REFERENCE LABEL FOR START/END POINT OF HIGHWAY / RIGHT OF WAY TO BE DIVERTED, CREATED, STOPPED UP OR EXTINGUISHED
  - PROPOSED GATE
  - PARISH BOUNDARY
  - MAINLINE CHAINAGE
  - NEW MAINTENANCE BAY

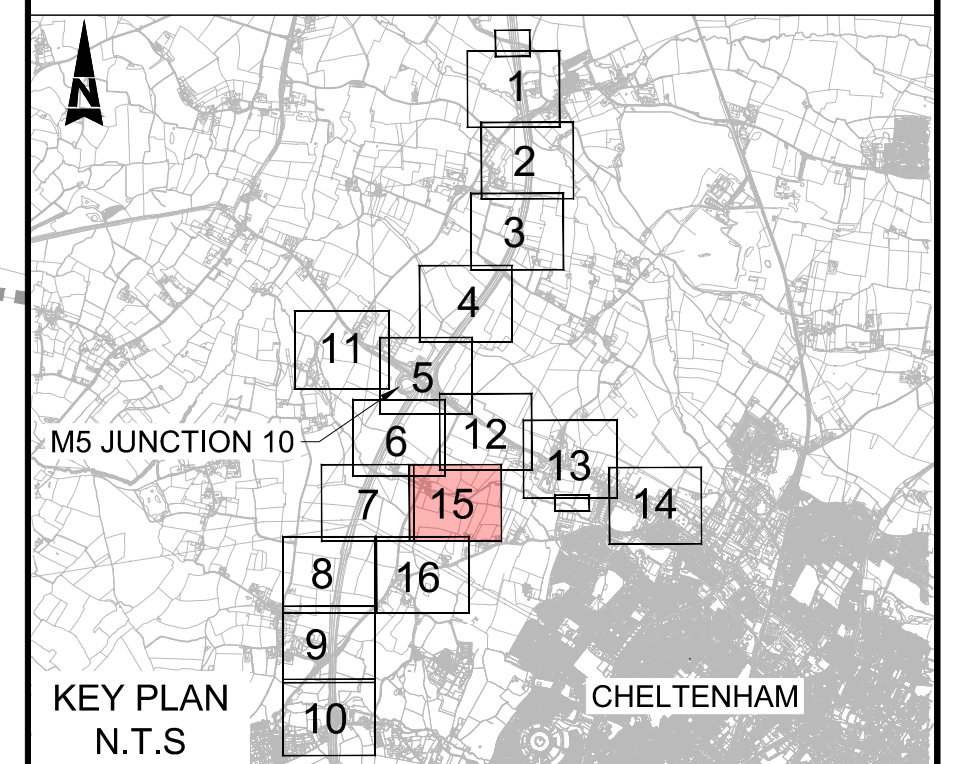

Description	Status	Revision	Drawn	Checked	Reviewed	Authorised	Issue Date
NOT USED	A1	C01	YP	YP	YP	YP	02/07/24
AMENDMENT TO PROW FP AUC11	A1	C02	VN	CG	CJ	LJ	02/09/24
CHANGE APPLICATION 2 AMENDMENTS INCLUDED	A1	C03	VN	CG	CJ	LJ	24/11/24

Drawing Suitability: APPROVED - PUBLISHED

Status: A1

Project Title: M5 Junction 10 Improvements Scheme

Drawing Title: STREETS, RIGHTS OF WAY AND ACCESS PLANS REGULATION 5(2)(k) SHEET 15 OF 16

Drawing Number: TR010063/APP/2.5

Original Size: A1 | Scale: 1:1250 | Project Ref. No: 5228847 | Sheet: 15 of 16 | Rev: C03



FOR CONTINUATION REFER TO SHEET 7

FOR CONTINUATION REFER TO SHEET 15

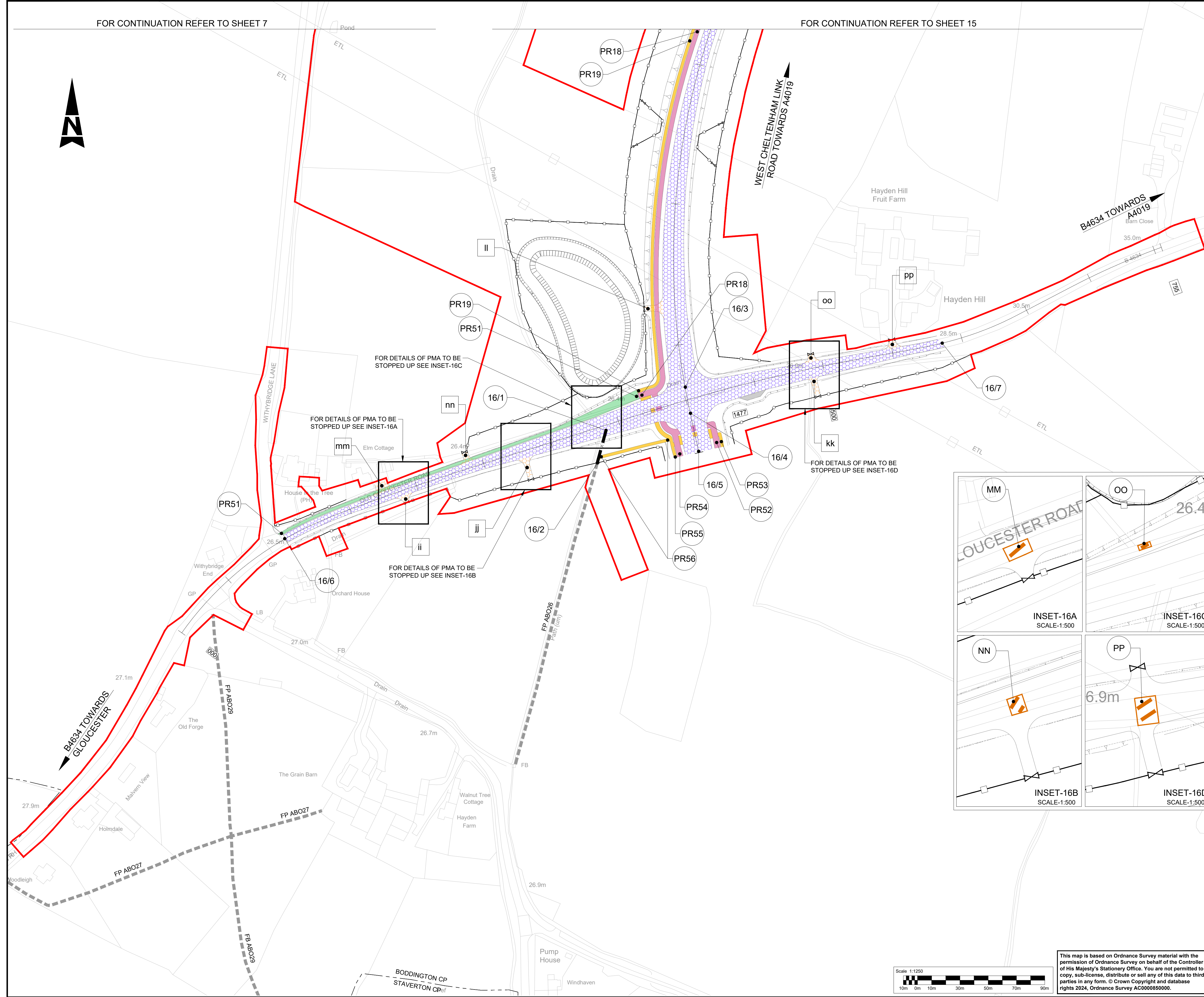

NOTES:

- THE STREETS, RIGHTS OF WAY AND ACCESS PLANS SHOULD BE READ IN CONJUNCTION WITH THE DEVELOPMENT CONSENT ORDER AND OTHER APPLICATION PLANS.

KEY:

- DEVELOPMENT CONSENT ORDER (DCO) LIMITS
- THE SCHEME (SHOWN FOR ILLUSTRATIVE PURPOSES ONLY)
- EXISTING ORDNANCE SURVEY DATA
- NEW, ALTERED OR IMPROVED HIGHWAY - MOTORWAY
- NEW, ALTERED OR IMPROVED HIGHWAY - SIDE ROADS
- NEW / ALTERED PRIVATE MEANS OF ACCESS
- NEW OR ALTERED FOOTWAY
- NEW CYCLE TRACK
- NEW NON SEGREGATED FOOTWAY / CYCLE TRACK
- EXISTING HIGHWAYS TO BE STOPPED UP
- PRIVATE MEANS OF ACCESS TO BE STOPPED UP
- FP XXX EXISTING PUBLIC RIGHT OF WAY (PROW)
- X EXISTING PUBLIC RIGHT OF WAY TO BE STOPPED UP
- NEW / SUBSTITUTED FOOTPATH
- NEW / SUBSTITUTED BRIDLEWAY
- PROPOSED FENCE LINE
- REFERENCE LABEL FOR NEW PUBLIC RIGHT OF WAY, FOOTWAY, CYCLE TRACK, OR COMBINED FOOTWAY AND CYCLE TRACK
- REFERENCE LABEL FOR EXISTING PRIVATE MEANS OF ACCESS TO BE STOPPED UP
- REFERENCE LABEL FOR NEW/SUBSTITUTED PRIVATE MEANS OF ACCESS
- REFERENCE LABEL FOR START/END POINT OF HIGHWAY / RIGHT OF WAY TO BE DIVERTED, CREATED, STOPPED UP OR EXTINGUISHED
- PROPOSED GATE
- PARISH BOUNDARY
- MAINLINE CHAINAGE
- NEW MAINTENANCE BAY

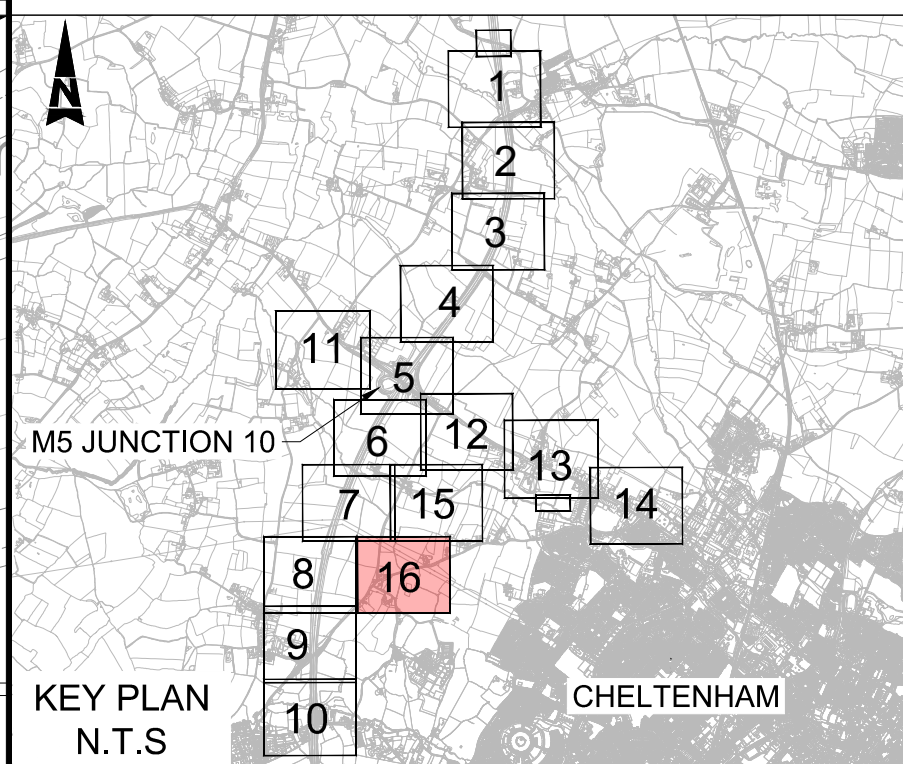
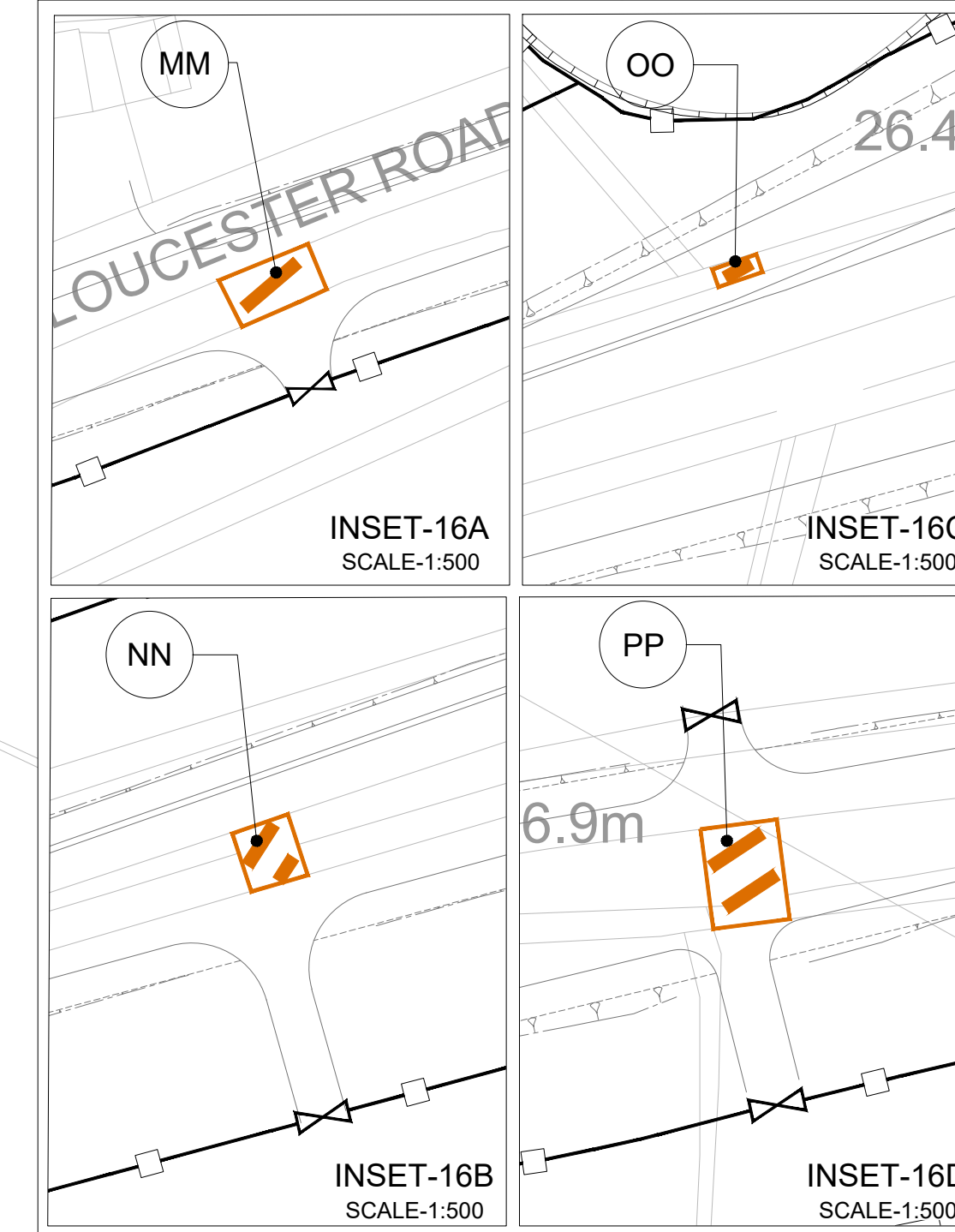

Description	Status	Revision	Drawn	Checked	Reviewed	Authorised	Issue Date

Description	Status	Revision	Drawn	Checked	Reviewed	Authorised	Issue Date
NOT USED	A1	C01	YP	YP	YP	YP	02/07/24

Description	Status	Revision	Drawn	Checked	Reviewed	Authorised	Issue Date
CHANGE APPLICATION 2 AMENDMENTS INCLUDED	A1	C02	VN	CG	CJ	LJ	24/11/24

APPROVED - PUBLISHED A1

Project Title: M5 Junction 10 Improvements Scheme

Drawing Title: STREETS, RIGHTS OF WAY AND ACCESS PLANS REGULATION 5(2)(k) SHEET 16 OF 16

Drawing Number: TR010063/APP/2.5

Original Size: A1	Scale: 1:1250	Project Ref. No: 5228847	Sheet: 16 of 16	Rev: C02
-------------------	---------------	--------------------------	-----------------	----------

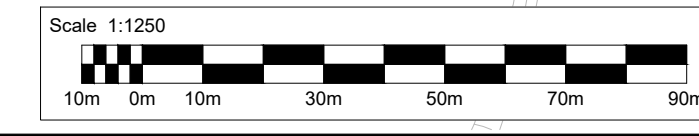

This map is based on Ordnance Survey material with the permission of Ordnance Survey on behalf of the Controller of His Majesty's Stationery Office. You are not permitted to copy, sub-license, distribute or sell any of this data to third parties in any form. © Crown Copyright and database rights 2024, Ordnance Survey AC0000850000.



# AtkinsRéalis

5th Floor, Block 5  
Shire Hall  
Bearland  
Gloucester  
GL1 2TH